

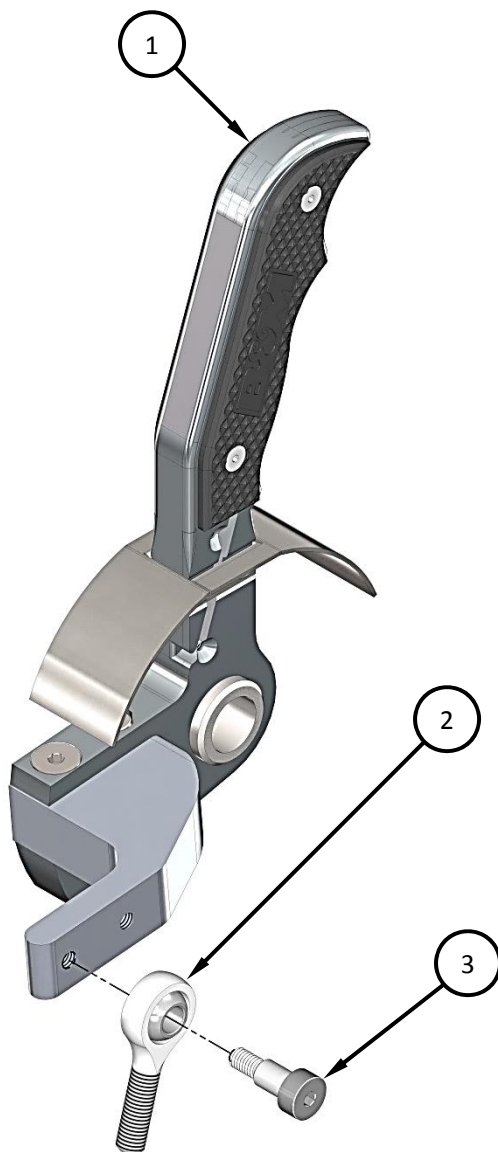

Installation Instructions for
81148
MAGNUM GRIP SHORT-THROW SHIFTER
2016-20 YAMAHA YXZ1000R SIDE BY SIDES
with manual clutch



PARTS LIST

ITEM NO.	PART NO.	DESCRIPTION	QTY.
1	N/A - SHIPS ASSEMBLED	SHIFTER ASSY W/MANUAL CLUTCH	1
2	3401563	ROD END, BALL, M8 × 1.25 RIGHT HAND THREAD	1
3	3401564	SCREW, SHOULDER M6 × 1.0 THREAD, 8MM DIA × 12MM LONG	1

Before starting, take a moment to read and understand these installation instructions for your B&M Magnum Grip Shifter. Use the parts drawing and list to verify your kit's contents. In the unlikely event of missing parts, please contact B&M Technical Support for replacements.

When removing fasteners, keep track of their locations to avoid fastener mix-ups at reassembly.

We highly recommend that you retain all factory parts replaced by this kit.

REMOVE THE STOCK SHIFTER:

1. **Securely chock the vehicle's wheels to keep it from rolling when the shifter or parking brake levers are manipulated.**

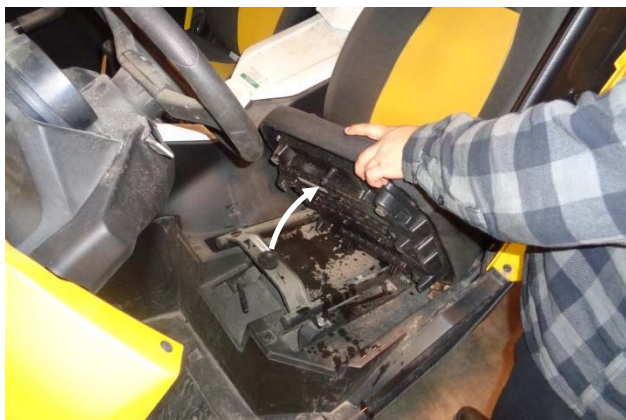

2. Remove both seats from the vehicle. First lift up sharply at the front of each seat bottom to release and remove the cushion.



3. Then remove the four bolts at each seat frame to remove the seat back.

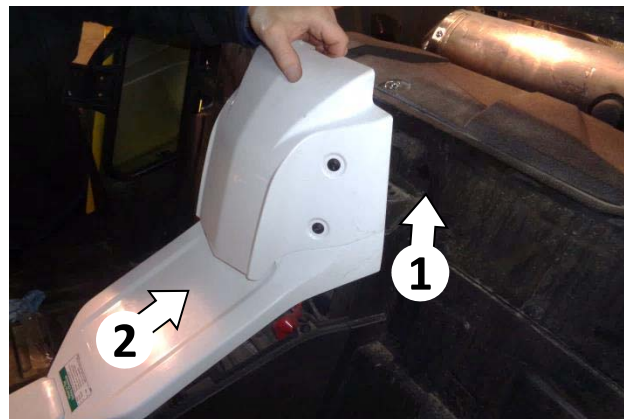

4. Remove the rear console cover. First grasp its rear end and firmly lift up to unsnap its two pins from their grommets. Then pull the cover slightly rearward to disengage the locating tab at the front.

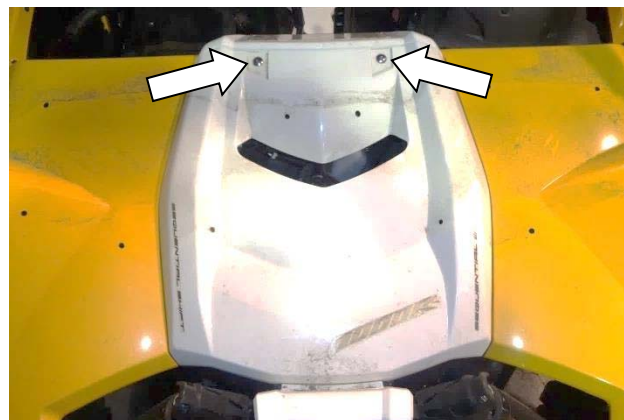

5. Remove the two screws at the rear of the service cover.

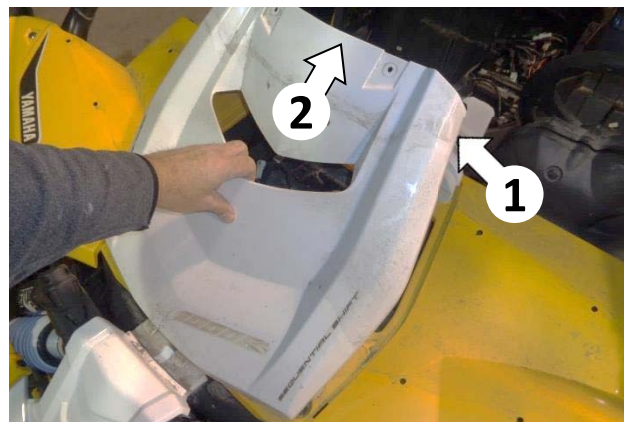

6. Remove the service cover by lifting up its rear end, then pulling the cover slightly rearward to disengage the locating tabs at the front.



7. Remove the two screws at the front end of the front console cover.



8. Use a plastic trim removal tool and a screwdriver to remove the plastic push rivet at the rear of the front console cover. Then remove the cover.

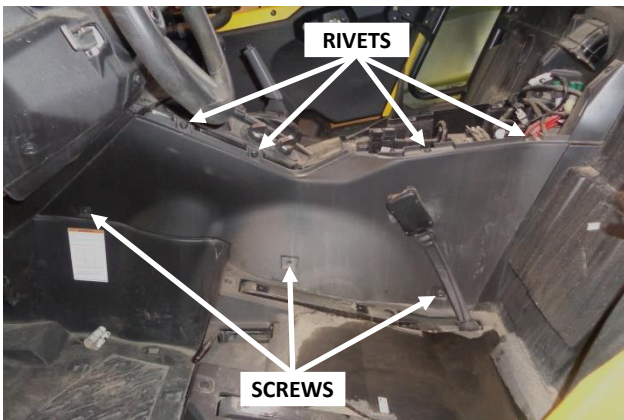

9. On the left console side cover, remove the four plastic push rivets along the top, and the three screws along the bottom.



10. Carefully remove the left console side cover.

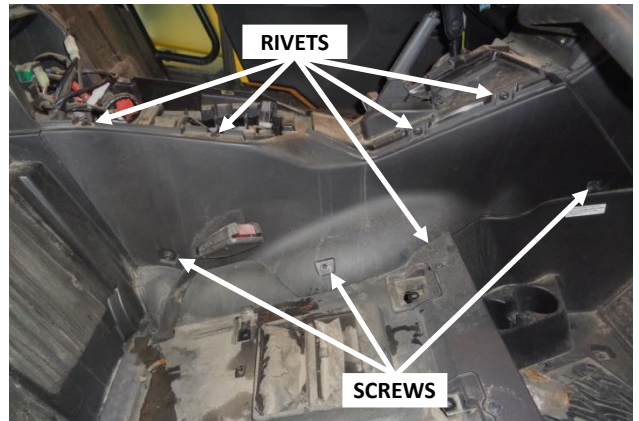

11. On the right console side cover, remove the five plastic push rivets (four along the top and one at the bottom), and the three screws along the bottom.



12. Carefully remove the right console side cover.

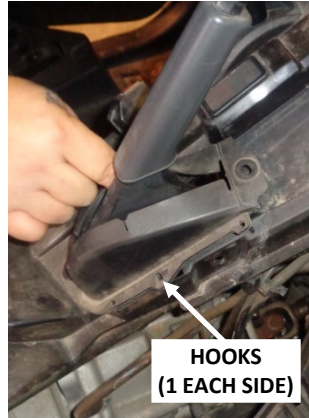
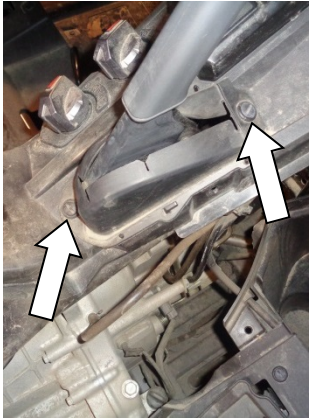

13. Remove the two plastic push rivets from the parking brake boot, then carefully detach the boot from the hook on each side and remove the boot.

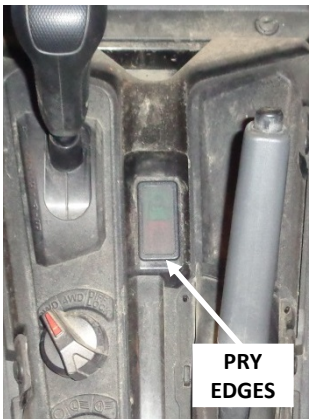

14. Remove the seat belt safety light from the switch panel by carefully prying around its edges. Then disconnect the electrical plug and remove the light from the vehicle.



15. Remove the bolt at the front end of the switch panel.



16. Carefully pry the plastic pin from the side of the shifter knob, then pull the knob up off the shift lever while twisting it side-to-side.



17. Under the switch panel, disconnect the two rotary switch lead plugs. Then remove the panel from the vehicle.

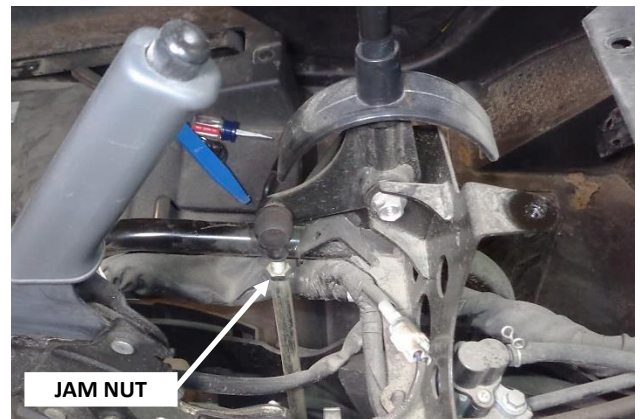

18. Loosen the jam nut between the rod end and the shift rod.



19. Remove the shift lever pivot nut and bolt, and retain them for use at Step 25.



20. Spin the shift lever counter-clockwise to remove it from the end of the shift rod.



21. Remove the steel bushing from the shift lever, then remove the two plastic sleeves. Retain sleeves and bushing for use at Steps 23 and 24.

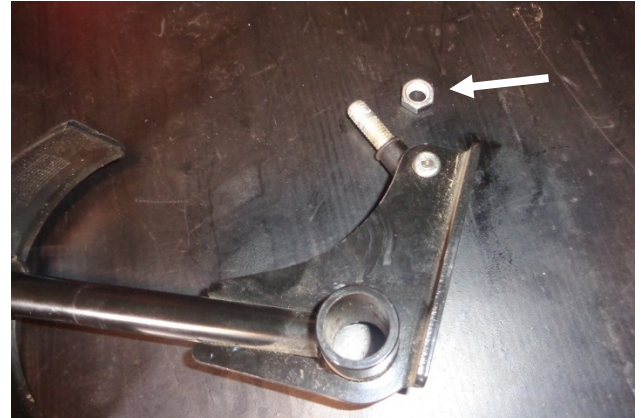

22. Remove the jam nut from the rod end and retain for use at Step 26.

INSTALL YOUR B&M SHIFTER:



23. Press one stock plastic sleeve fully into each end of the steel pivot sleeve in the shifter assembly (1).

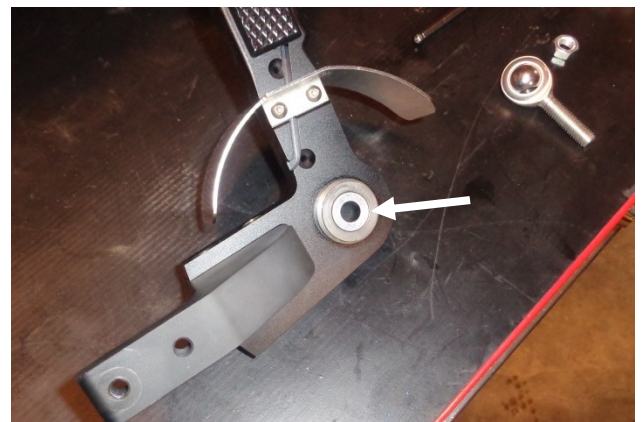

24. Press the stock steel bushing into the plastic sleeves.



25. Install the shifter assembly in the shifter support frame using the stock pivot bolt and nut.



26. Thread the stock jam nut about halfway onto the rod end (2), then thread the rod end into the shifter rod. Make note of the over-travel stop pad on the frame for shifter adjustment at Step 28.

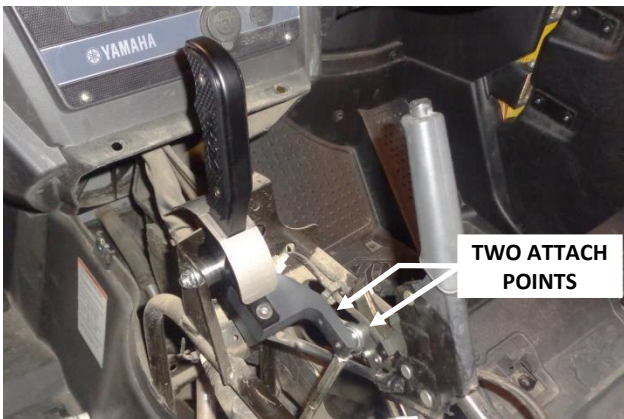

27. Fasten the rod end to the shifter assembly with the shoulder screw (3), then tighten the jam nut.
NOTE: Both attach points reduce shifter throw compared to the stock shifter; the rearward attach point reduces shifter throw the most.

28. Check shift rod adjustment as follows:

- A. Pull the shift lever back fully to the up-shift position and hold it there. **NOTE: Verify the shift lever is fully in the up-shift position by rocking the vehicle back and forth on its wheels.**

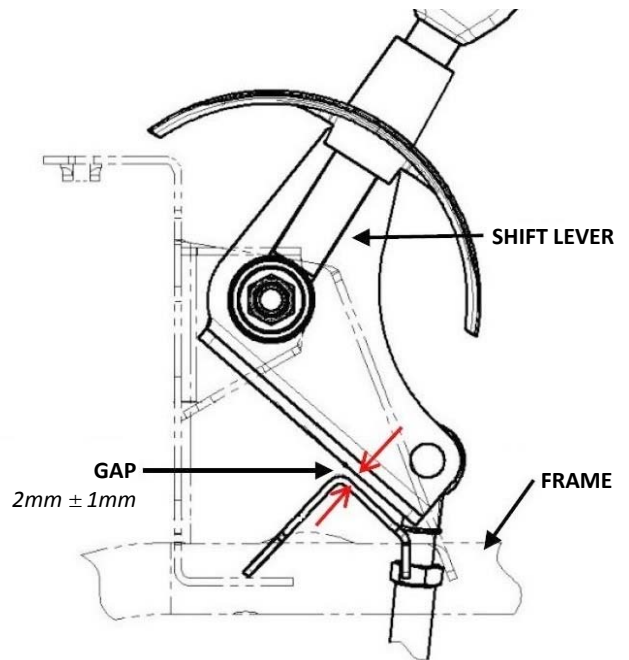

- B. Verify that the gap between the shift lever and the over-travel stop pad is 2mm \pm 1mm (0.079 in. \pm 0.039 in.).

- C. If necessary, adjust the gap as follows:

- Increase the gap by turning the rod end counter-clockwise (out of the shift rod).
- Decrease the gap by turning the rod end clockwise (into the shift rod).

One full turn of the rod end gives approximately 1.25mm (0.049") adjustment.

NOTE: ALWAYS TIGHTEN THE SHOULDER SCREW AND JAM NUT BEFORE CHECKING THE GAP.

- D. Shift up and down through a few gears, then re-check the gap. If it is out of adjustment, repeat this step.



29. Place the switch panel over the shifter and parking brake handles.



30. Reconnect the two rotary switch lead plugs.
NOTE: The plugs have different shapes to prevent misconnection.



31. Reconnect the seat belt safety light to its electrical plug, then press the light back into the switch panel.



32. Reinstall the bolt at the front of the switch panel.

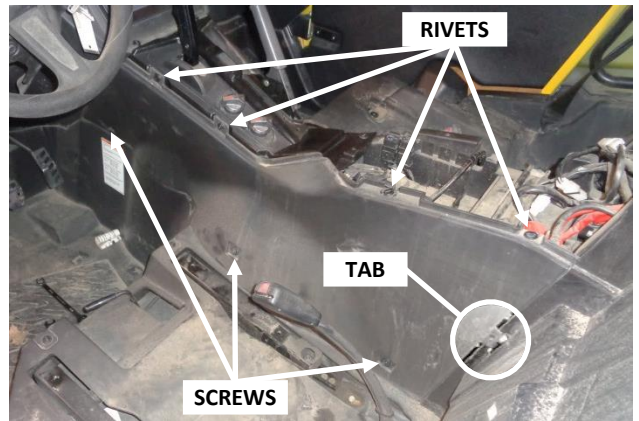

33. Reinstall the left console side cover. First insert the cover's locating tab in its slot. Then fasten the cover with its four plastic push rivets along the top, and its three screws along the bottom.

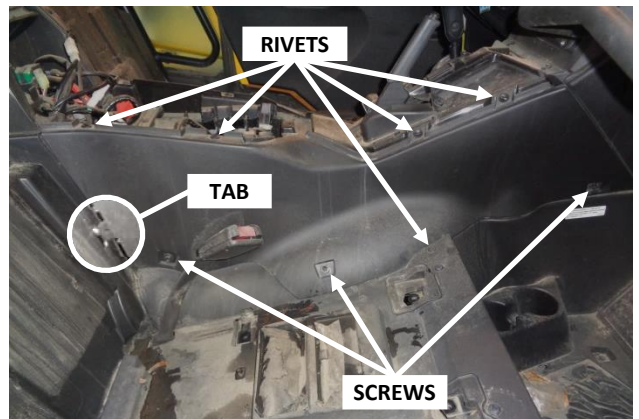

34. Reinstall the right console side cover in the same manner: Insert the locating tab in its slot, then fasten the cover with its five plastic push rivets (four along the top and one at the bottom), and its three screws along the bottom.

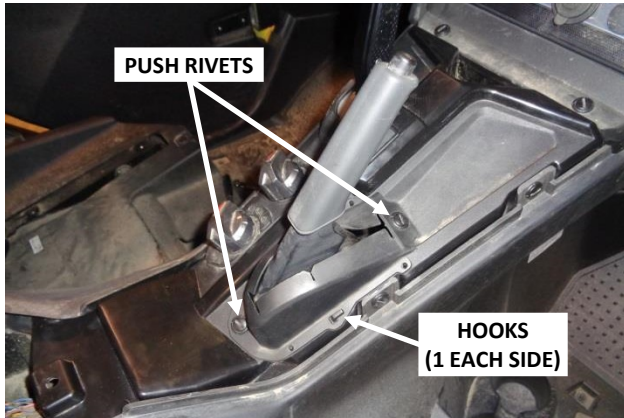

35. Slip the dust boot over the parking brake lever. Carefully attach the boot to the hook on each side, then install the two plastic push rivets.

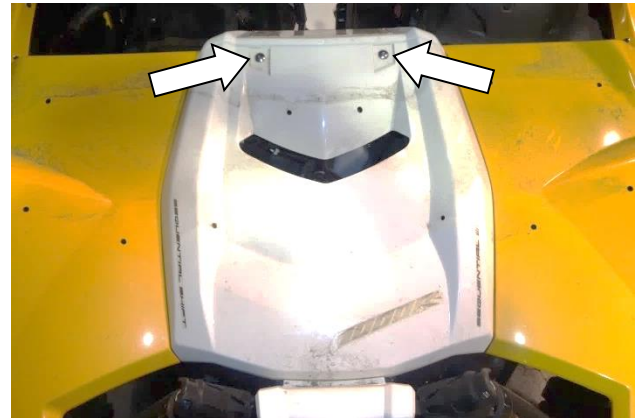

38. Fasten the service cover to the vehicle with its two screws.

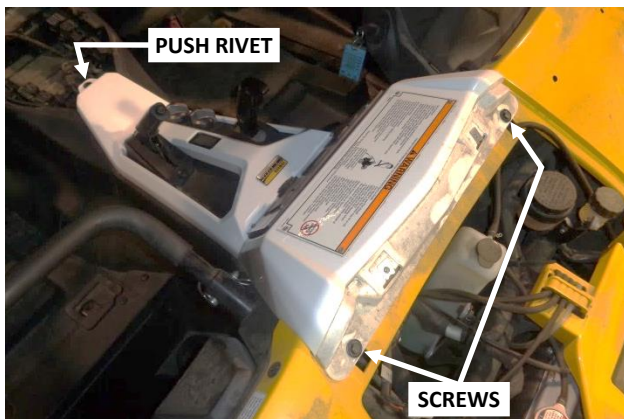

36. Reinstall the front console cover. Fasten it to the vehicle with the plastic push rivet at the rear, and the two screws at the front.

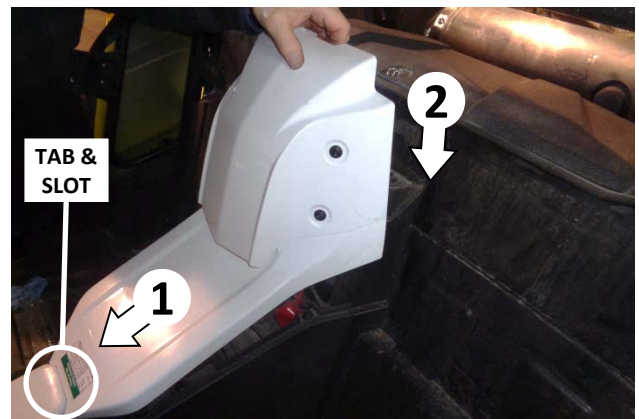

39. Reinstall the rear console cover by inserting the front locating tab into its slot, then firmly pushing the rear end down until the cover snaps into place.



37. Insert the four tabs at the front of the service cover into their respective slots and lay the cover in place.



40. Reinstall the seat backs, fastening each one to the vehicle with its four bolts.



41. Reinstall each seat cushion. First slip its rear tabs under the retaining rod, then push the cushion down firmly until its pin snaps into the grommet.



Congratulations, the installation of your B&M Magnum Grip Short-Throw Shifter is now complete!

IMPORTANT: RETAIN THESE INSTRUCTIONS FOR FUTURE REFERENCE

